

5. REPORT

Background

5.1 An application for a New Premises Licence, by Bahra Daban in respect of Hanci Restaurant, 6 Grand Parade, Green Lanes, London N4 1JX for the sale of alcohol and late night refreshment under the Licensing Act 2003.

5.2 Details of the application being sought under the Premises Licence– APP 1

The Provision of

Supply of Alcohol

Monday to Friday	1100 to 0200
Sunday	1100 to 0100

For consumption ON the premises

Late Night Refreshment

Monday to Friday	2300 to 0200
Sunday	2300 to 0100

Hours open to the public

Monday to Friday	0700 to 0200
Sunday	0800 to 0100

General-all four licensing objectives

Staff to be trained regularly on licensing provisions and this to be documented.

5.3 Crime and Disorder

All instances of crime and disorder shall be reported to the Police.

An incident book shall be used to record all instances of public disorder. CCTV shall be installed, operated and maintained in agreement with the Police. The system will enable frontal identification of every person entering the premises. The system shall record in real time and operate whilst the premises are open for licensable activities. The recordings shall be kept available for a minimum of 31 days. Recordings shall be made available to an authorised officer or a Police Officer (subject to the Data Protection Act 1998) within 24 hours of any request.

5.4 Public Safety

To comply with Fire Regulations and the provisions of Management Regulations.

Maintain and check systems in place, smoke detectors, fire extinguishers, emergency safety lighting and fire alarms.

LICENSING ACT 2003

Sec 24

5.5 Public Nuisance

Discourage noise from patrons arriving at, queuing or departing from the premises by displaying polite notices for customers' attention.

5.6 Child Protection

The Licensee shall adopt the 'Challenge 25', the retail of alcohol standards group's advice for off licences.

The Licensee shall ensure that staff are trained about age restricted products and ensure that they sign to confirm that they have understood the training. The Licensee shall keep records of training and instruction given to staff.

The Licensee shall put arrangements in place to ensure that before serving alcohol to young persons, staff ask to see, accredited proof of age cards for example proof of age cards carrying the 'Pass' logo, a passport, or UK drivers licence bearing the photograph and the date of birth of the bearer.

The Licensee shall require staff to note any refusals to sell to young people in a refusals log.

6. RELEVANT REPRESENTATIONS (CONSULTATION)

Responsible authorities:

6.1 Comments of Metropolitan Police

Have made representation regarding this application **Appendix 2**

6.2 Comments of Regulatory Services:

Environmental Health

Have made no representation to this application

Trading Standards

Have made no representation to this application

6.3 London Fire and Civil Defence Authority

Have made no representation to this application

6.4 Planning Services

Have made no representation to this application

LICENSING ACT 2003

Sec 24

6.5 Comments of Child Protection Agency or Nominee

No representation made on this matter

7.0 Interested Parties

One letter of representation has been received against this application
Appendix 3

8.0 Financial Comments

The fee which would be applicable for this application was **£190.00.**

APPENDIX 1 – APPLICATION

AG106082
WK/259020

Application for a premises licence to be granted
under the Licensing Act 2003

PLEASE READ THE FOLLOWING INSTRUCTIONS FIRST

Before completing this form please read the guidance notes at the end of the form.
If you are completing this form by hand please write legibly in block capitals. In all cases ensure that your answers are inside the boxes and written in black ink. Use additional sheets if necessary.
You may wish to keep a copy of the completed form for your records.

I/We Ms BAHRA DABAN

(Insert name(s) of applicant)

apply for a premises licence under section 17 of the Licensing Act 2003 for the premises described in Part 1 below (the premises) and I/we are making this application to you as the relevant licensing authority in accordance with section 12 of the Licensing Act 2003

Part 1 – Premises Details

Postal address of premises or, if none, Ordnance Survey map reference or description HANCI RESTAURANT, 6 GRAND PARADE, GREEN LANES		 Urban Environment Haringey Council - 7 AUG 2013 RECEIVED TECHNOPARK, ASHLEY ROAD, N17 9LN	
Post town	LONDON	Post code	N4 1JX
Telephone number at premises (if any)			
Non-domestic rateable value of premises	£19750		

Part 2 - Applicant Details

Please state whether you are applying for a premises licence as
Please tick yes

- a) an individual or individuals * please complete section (A)
- b) a person other than an individual *
- i. as a limited company please complete section (B)
- ii. as a partnership please complete section (B)
- iii. as an unincorporated association or please complete section (B)
- iv. other (for example a statutory corporation) please complete section (B)
- c) a recognised club please complete section (B)
- d) a charity please complete section (B)

- e) the proprietor of an educational establishment please complete section (B)
- f) a health service body please complete section (B)
- g) a person who is registered under Part 2 of the Care Standards Act 2000 (c14) in respect of an independent hospital in Wales please complete section (B)
- ga) a person who is registered under Chapter 2 of Part 1 of the Health and Social Care Act 2008 (within the meaning of that Part) in an independent hospital in England please complete section (B)
- h) the chief officer of police of a police force in England and Wales please complete section (B)

* If you are applying as a person described in (a) or (b) please confirm:

Please tick yes

- I am carrying on or proposing to carry on a business which involves the use of the premises for licensable activities; or
- I am making the application pursuant to a
 - statutory function or
 - a function discharged by virtue of Her Majesty's prerogative

(A) INDIVIDUAL APPLICANTS (fill in as applicable)

Mr <input type="checkbox"/>	Mrs <input type="checkbox"/>	Miss <input type="checkbox"/>	Ms <input checked="" type="checkbox"/>	Other Title (for example, Rev)	
Surname DABAN,			First names BAHRA		
I am 18 years old or over				<input checked="" type="checkbox"/>	Please tick yes
Current postal address if different from premises address					
Post Town				Postcode	
Daytime contact telephone number					
E-mail address (optional)					

SECOND INDIVIDUAL APPLICANT (if applicable)

Mr <input type="checkbox"/>	Mrs <input type="checkbox"/>	Miss <input type="checkbox"/>	Ms <input type="checkbox"/>	Other Title (for example, Rev)	
Surname			First names		

I am 18 years old or over		<input type="checkbox"/> Please tick yes	
Current postal address if different from premises address			
Post Town		Postcode	
Daytime contact telephone number			
E-mail address (optional)			

(B) OTHER APPLICANTS

Please provide name and registered address of applicant in full. Where appropriate please give any registered number. In the case of a partnership or other joint venture (other than a body corporate), please give the name and address of each party concerned.

Name
Address
Registered number (where applicable)
Description of applicant (for example, partnership, company, unincorporated association etc.)
Telephone number (if any)
E-mail address (optional)

Part 3 Operating Schedule

When do you want the premises licence to start?

Day	Month	Year
<input type="text"/>	<input type="text"/>	<input type="text"/>

If you wish the licence to be valid only for a limited period, when do you want it to end?

Day	Month	Year
<input type="text"/>	<input type="text"/>	<input type="text"/>

Please give a general description of the premises (please read guidance note1)
RESTAURANT

If 5,000 or more people are expected to attend the premises at any one time, please state the number expected to attend.

What licensable activities do you intend to carry on from the premises?

(Please see sections 1 and 14 of the Licensing Act 2003 and Schedules 1 and 2 to the Licensing Act 2003)

Provision of regulated entertainment

Please tick yes

- a) plays (if ticking yes, fill in box A)
- b) films (if ticking yes, fill in box B)
- c) indoor sporting events (if ticking yes, fill in box C)
- d) boxing or wrestling entertainment (if ticking yes, fill in box D)
- e) live music (if ticking yes, fill in box E)
- f) recorded music (if ticking yes, fill in box F)
- g) performances of dance (if ticking yes, fill in box G)
- h) anything of a similar description to that falling within (e), (f) or (g) (if ticking yes, fill in box H)

Provision of entertainment facilities:

- i) making music (if ticking yes, fill in box I)
- j) dancing (if ticking yes, fill in box J)
- k) entertainment of a similar description to that falling within (i) or (j) (if ticking yes, fill in box K)

Provision of late night refreshment (if ticking yes, fill in box L)

Supply of alcohol (if ticking yes, fill in box M)

In all cases complete boxes N, O and P

A

Please Standard days and timings (please read guidance note 6)		Will the performance of a club take place indoors or outdoors or both – please tick (please read guidance note 2)		Indoors		Outdoors		Both	
Day	Start	Finish			<input type="checkbox"/>	<input type="checkbox"/>	<input type="checkbox"/>	<input type="checkbox"/>	<input type="checkbox"/>
Mon			Please give further details here (please read guidance note 3)						
Tue									
Wed			State any seasonal variations for performance dates (please read guidance note 4)						
Thur									
Fri			Non-standard limiters. Where you intend to use the premises for the performance of a club, please list the dates and times in the column on the left, please tick (please read guidance note 5)						
Sat									
Sun									

B

Please Standard days and timings (please read guidance note 6)		Will the exhibition of films take place indoors or outdoors or both – please tick (please read guidance note 2)		Indoors		Outdoors		Both	
Day	Start	Finish			<input type="checkbox"/>	<input type="checkbox"/>	<input type="checkbox"/>	<input type="checkbox"/>	<input type="checkbox"/>
Mon			Please give further details here (please read guidance note 3)						
Tue									
Wed			State any seasonal variations for the exhibition of films (please read guidance note 4)						
Thur									
Fri			Non-standard limiters. Where you intend to use the premises for the exhibition of films at different times to those listed in the column on the left, please tick (please read guidance note 5)						
Sat									
Sun									

C

Please Standard days and timings (please read guidance note 6)		Will the exhibition of films take place indoors or outdoors or both – please tick (please read guidance note 2)		Indoors		Outdoors		Both	
Day	Start	Finish			<input type="checkbox"/>	<input type="checkbox"/>	<input type="checkbox"/>	<input type="checkbox"/>	<input type="checkbox"/>
Mon			Please give further details here (please read guidance note 3)						
Tue									
Wed			State any seasonal variations for indoor exhibition events (please read guidance note 4)						
Thur									
Fri			Non-standard limiters. Where you intend to use the premises for the exhibition of films at different times to those listed in the column on the left, please tick (please read guidance note 5)						
Sat									
Sun									

D

Please Standard days and timings (please read guidance note 6)		Will the boxing or wrestling entertainment take place indoors or outdoors or both – please tick (please read guidance note 2)		Indoors		Outdoors		Both	
Day	Start	Finish			<input type="checkbox"/>	<input type="checkbox"/>	<input type="checkbox"/>	<input type="checkbox"/>	<input type="checkbox"/>
Mon			Please give further details here (please read guidance note 3)						
Tue									
Wed			State any seasonal variations for boxing or wrestling entertainment (please read guidance note 4)						
Thur									
Fri			Non-standard limiters. Where you intend to use the premises for boxing or wrestling entertainment at different times to those listed in the column on the left, please tick (please read guidance note 5)						
Sat									
Sun									

E

Please Standard days and timings (please read guidance note 6)		Will the performance of live music take place indoors or outdoors or both – please tick (please read guidance note 2)		Indoors		Outdoors		Both	
Day	Start	Finish			<input type="checkbox"/>	<input type="checkbox"/>	<input type="checkbox"/>	<input type="checkbox"/>	<input type="checkbox"/>
Mon			Please give further details here (please read guidance note 3)						
Tue									
Wed			State any seasonal variations for the performance of live music (please read guidance note 4)						
Thur									
Fri			Non-standard limiters. Where you intend to use the premises for the performance of live music at different times to those listed in the column on the left, please tick (please read guidance note 5)						
Sat									
Sun									

F

Please Standard days and timings (please read guidance note 6)		Will the playing of recorded music take place indoors or outdoors or both – please tick (please read guidance note 2)		Indoors		Outdoors		Both	
Day	Start	Finish			<input type="checkbox"/>	<input type="checkbox"/>	<input type="checkbox"/>	<input type="checkbox"/>	<input type="checkbox"/>
Mon			Please give further details here (please read guidance note 3)						
Tue									
Wed			State any seasonal variations for the playing of recorded music (please read guidance note 4)						
Thur									
Fri			Non-standard limiters. Where you intend to use the premises for the playing of recorded music at different times to those listed in the column on the left, please tick (please read guidance note 5)						
Sat									
Sun									

G

Performances of dance Standard days and times (please read guidance note 6)		Will the performance of dance take place indoors or outdoors or both – please tick (please read guidance note 2)		Indoors <input type="checkbox"/>	Outdoors <input type="checkbox"/>	Both <input type="checkbox"/>
Day	Start	Finish	Please give further details here (please read guidance note 3)			
Mon						
Tue						
Wed						
Thur						
Fri			State any seasonal variations for the performance of dance (please read guidance note 4)			
Sat			Non standard timings. Where you intend to use the premises for the performance of dance at different times to those listed in the column on the left, please tick (please read guidance note 5)			
Sun						

H

Anything of a similar description to that falling within (e), (f) or (g) Standard days and times (please read guidance note 6)		Please give a description of the type of entertainment you will be providing		Will this entertainment take place indoors or outdoors or both – please tick (please read guidance note 2)		Indoors <input type="checkbox"/>	Outdoors <input type="checkbox"/>	Both <input type="checkbox"/>
Day	Start	Finish	Please give further details here (please read guidance note 3)					
Mon								
Tue								
Wed								
Thur			State any seasonal variations for entertainment of a similar description to that falling within (e), (f) or (g) (please read guidance note 4)					
Fri			Non standard timings. Where you intend to use the premises for the entertainment of a similar description to that falling within (e), (f) or (g) at different times to those listed in the column on the left, please tick (please read guidance note 5)					
Sat								
Sun								

I

Provision of facilities for making music (please read guidance note 6)		Please give a description of the facilities for making music you will be providing		Will the facilities for making music be indoors or outdoors or both – please tick (please read guidance note 2)		Indoors <input type="checkbox"/>	Outdoors <input type="checkbox"/>	Both <input type="checkbox"/>
Day	Start	Finish	Please give further details here (please read guidance note 3)					
Mon								
Tue								
Wed			State any seasonal variations for the provision of facilities for making music (please read guidance note 4)					
Thur			Non standard timings. Where you intend to use the premises for the provision of facilities for making music at different times to those listed in the column on the left, please tick (please read guidance note 5)					
Fri								
Sat								
Sun								

J

Provision of facilities for dancing (please read guidance note 6)		Will the facilities for dancing be indoors or outdoors or both – please tick (please read guidance note 2)		Indoors <input type="checkbox"/>	Outdoors <input type="checkbox"/>	Both <input type="checkbox"/>
Day	Start	Finish	Please give further details here (please read guidance note 3)			
Mon						
Tue						
Wed			State any seasonal variations for providing dancing facilities (please read guidance note 4)			
Thur			Non standard timings. Where you intend to use the premises for the provision of facilities for dancing entertainment at different times to those listed in the column on the left, please tick (please read guidance note 5)			
Fri						
Sat						
Sun						

K

Provision of facilities for entertainment (please read guidance note 6)		Please give a description of the type of entertainment facility you will be providing		Will this entertainment facility be indoors or outdoors or both – please tick (please read guidance note 2)		Indoors <input type="checkbox"/>	Outdoors <input type="checkbox"/>	Both <input type="checkbox"/>
Day	Start	Finish	Please give further details here (please read guidance note 3)					
Mon								
Tue								
Wed								
Thur			State any seasonal variations for the provision of facilities for entertainment of a similar description to that falling within (e) or (f) (please read guidance note 4)					
Fri			Non standard timings. Where you intend to use the premises for the entertainment of a similar description to that falling within (e) or (f) at different times to those listed in the column on the left, please tick (please read guidance note 5)					
Sat								
Sun								

L

Late night refreshment Standard days and timings (please read guidance note 6)			Will the provision of late night refreshment take place indoors or outdoors or both – please tick (please read guidance note 2)	Indoors	<input checked="" type="checkbox"/>
				Outdoors	<input type="checkbox"/>
				Both	<input type="checkbox"/>
Day	Start	Finish			
Mon	23:00	02:00	<u>Please give further details here</u> (please read guidance note 3)		
Tue	23:00	02:00			
Wed	23:00	02:00	<u>State any seasonal variations for the provision of late night refreshment</u> (please read guidance note 4)		
Thur	23:00	02:00			
Fri	23:00	02:00	<u>Non standard timings. Where you intend to use the premises for the provision of late night refreshment at different times, to those listed in the column on the left, please list</u> (please read guidance note 5)		
Sat	23:00	02:00			
Sun	23:00	01:00			

M

Supply of alcohol Standard days and timings (please read guidance note 6)			Will the supply of alcohol be for consumption (Please tick box) (please read guidance note 7)	On the premises	<input checked="" type="checkbox"/>
				Off the premises	<input type="checkbox"/>
				Both	<input type="checkbox"/>
Day	Start	Finish	State any seasonal variations for the supply of alcohol (please read guidance note 4) NONE		
Mon	11:00	02:00			
Tue	11:00	02:00			
Wed	11:00	02:00			
Thur	11:00	02:00			
Fri	11:00	02:00			
Sat	11:00	02:00			
Sun	11:00	01:00			
			Non standard timings. Where you intend to use the premises for the supply of alcohol at different times to those listed in the column on the left, please list (please read guidance note 5)		

State the name and details of the individual whom you wish to specify on the licence as premises supervisor

Name Mr OZGEN BALCI	
Address 54 DYSON HOUSE BLACKHALL LANE	
Postcode	SE10 0RE
Personal Licence number (if known) LN/000006777	
Issuing licensing authority (if known) GREENWICH	

N

Please highlight any adult entertainment or services, activities, other entertainment or matters ancillary to the use of the premises that may give rise to concern in respect of children (please read guidance note 8)
 N/A

O

Hours premises are open to the public Standard days and timings (please read guidance note 6)			State any seasonal variations (please read guidance note 4) NONE
Day	Start	Finish	Non standard timings. Where you intend the premises to be open to the public at different times from those listed in the column on the left, please list (please read guidance note 5)
Mon	07:00	02:00	
Tue	07:00	02:00	
Wed	07:00	02:00	
Thur	07:00	02:00	
Fri	07:00	02:00	
Sat	07:00	02:00	
Sun	08:00	01:00	

P Describe the steps you intend to take to promote the four licensing objectives:

a) General – all four licensing objectives (b,c,d,e) (please read guidance note 9)

- STAFF TO BE TRAINED REGULARLY ON LICENSING PROVISIONS AND THIS TO BE DOCUMENTED.

b) The prevention of crime and disorder

- ALL INSTANCES OF CRIME AND DISORDER SHALL BE REPORTED TO THE POLICE.
- AN INCIDENT BOOK SHALL BE USED TO RECORD ALL INSTANCES OF PUBLIC DISORDER.

- CCTV SHALL BE INSTALLED, OPERATED AND MAINTAINED IN AGREEMENT WITH THE POLICE. THE SYSTEM WILL ENABLE FRONTAL IDENTIFICATION OF EVERY PERSON ENTERING THE PREMISES. THE SYSTEM SHALL RECORD IN REAL TIME AND OPERATE WHILST THE PREMISES ARE OPEN FOR LICENSABLE ACTIVITIES. THE RECORDINGS SHALL BE KEPT AVAILABLE FOR A MINIMUM OF 31DAYS. RECORDINGS SHALL BE MADE AVAILABLE TO AN AUTHORISED OFFICER OR A POLICE OFFICER (SUBJECT TO THE DATA PROTECTION ACT 1998) WITHIN 24HRS OF ANY REQUEST.

c) Public safety

- TO COMPLY WITH THE FIRE REGULATIONS AND THE PROVISIONS OF THE MANAGEMENT REGULATIONS.

- MAINTAIN AND CHECK SYSTEMS IN PLACE, SMOKE DETECTORS, FIRE EXTINGUISHERS, EMERGENCY SAFETY LIGHTING AND FIRE ALARMS.

d) The prevention of public nuisance

DISCOURAGE NOISE FROM PATRONS ARRIVING AT, QUEUING OR DEPARTING FROM THE PREMISES BY DISPLAYING POLITE NOTICES FOR CUSTOMERS' ATTENTION.

e) The protection of children from harm

- THE LICENSEE SHALL ADOPT THE CHALLENGE 25, THE RETAIL OF ALCOHOL STANDARDS GROUP'S ADVICE FOR OFF-LICENSES.
 - THE LICENSEE SHALL ENSURE THAT STAFF ARE TRAINED ABOUT AGE RESTRICTED PRODUCTS AND ENSURE THAT THEY SIGN TO CONFIRM THAT THEY HAVE UNDERSTOOD THE TRAINING. THE LICENSEE SHALL KEEP RECORDS OF TRAINING AND INSTRUCTION GIVEN TO STAFF.
 - THE LICENSEE SHALL PUT ARRANGEMENTS IN PLACE TO ENSURE THAT BEFORE SERVING ALCOHOL TO YOUNG PERSONS, STAFF ASK TO SEE ACREDITED PROOF OF AGE CARDS FOR EXAMPLE PROOF OF AGE CARDS CARRYING THE 'PASS' LOGO, A PASSPORT, OR UK DRIVERS LICENCE BEARING THE PHOTOGRAPH AND THE DATE OF BIRTH OF THE BEARER.
 -THE LICENSEE SHALL REQUIRE STAFF TO NOTE ANY REFUSALS TO SELL TO YOUNG PEOPLE IN A REFUSALS LOG.

Please tick yes

- I have made or enclosed payment of the fee
- I have enclosed the plan of the premises
- I have sent copies of this application and the plan to responsible authorities and others where applicable
- I have enclosed the consent form completed by the individual I wish to be premises supervisor, if applicable
- I understand that I must now advertise my application
- I understand that if I do not comply with the above requirements my application will be rejected

IT IS AN OFFENCE, LIABLE ON CONVICTION TO A FINE UP TO LEVEL 5 ON THE STANDARD SCALE, UNDER SECTION 158 OF THE LICENSING ACT 2003 TO MAKE A FALSE STATEMENT IN OR IN CONNECTION WITH THIS APPLICATION

Part 4 – Signatures (please read guidance note 10)

Signature of applicant or applicant's solicitor or other duly authorised agent (See guidance note 11). **If signing on behalf of the applicant please state in what capacity.**

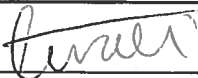
Signature	
Date	06/08/2013
Capacity	AGENT

For joint applications signature of 2nd applicant or 2nd applicant's solicitor or other authorised agent. (please read guidance note 12). **If signing on behalf of the applicant please state in what capacity.**

Signature	
Date	

Capacity	
----------	--

Contact name (where not previously given) and postal address for correspondence associated with this application (please read guidance note 13)			
MR TURABI AY ANVA 109 BAWDSEY AVENUE			
Post town	ILFORD	Post code	IG2 7TN
Telephone number (if any)	07710942923		
If you would prefer us to correspond with you by e-mail your e-mail address (optional)			
INFO@A-ANVA.CO.UK			

Notes for Guidance

1. Describe the premises. For example the type of premises, its general situation and layout and any other information which could be relevant to the licensing objectives. Where your application includes off-supplies of alcohol and you intend to provide a place for consumption of these off-supplies you must include a description of where the place will be and its proximity to the premises.
2. Where taking place in a building or other structure please tick as appropriate. Indoors may include a tent.
3. For example the type of activity to be authorised, if not already stated, and give relevant further details, for example (but not exclusively) whether or not music will be amplified or unamplified.
4. For example (but not exclusively), where the activity will occur on additional days during the summer months.
5. For example (but not exclusively), where you wish the activity to go on longer on a particular day e.g. Christmas Eve.
6. Please give timings in 24 hour clock (e.g. 16:00) and only give details for the days of the week when you intend the premises to be used for the activity.
7. If you wish people to be able to consume alcohol on the premises please tick on, if you wish people to be able to purchase alcohol to consume away from the premises please tick off. If you wish people to be able to do both please tick both.
8. Please give information about anything intended to occur at the premises or ancillary to the use of the premises which may give rise to concern in respect of children, regardless of whether you intend children to have access to the premises, for example (but not exclusively) nudity or semi-nudity, films for restricted age groups, the presence of gaming machines.
9. Please list here steps you will take to promote all four licensing objectives together.
10. The application form must be signed.
11. An applicant's agent (for example solicitor) may sign the form on their behalf provided that they have actual authority to do so.
12. Where there is more than one applicant, both applicants or their respective agents must sign the application form.
13. This is the address which we shall use to correspond with you about this application.

Consent of individual to being specified as premises supervisor

I MR OZGEN BALCI
[full name of prospective premises supervisor]

of 54 DYSON HOUSE
BLACKHALL LANE
LONDON SE10 0RE
[home address of prospective premises supervisor]

hereby confirm that I give my consent to be specified as the designated premises supervisor in relation to the application for

PREMISES LICENCE [type of application]

by MS BAHRA DARAN [name of applicant]

relating to a premises licence [number of existing licence, if any]

for HANCI RESTAURANT, 6 GRAND PARADE
GREEN LANES, LONDON N4 1JX

[name and address of premises to which the application relates]

and any premises licence to be granted or varied in respect of this application made

by MS BAHRA DARAN [name of applicant]

concerning the supply of alcohol at HANCI RESTAURANT
6 GRAND PARADE, GREEN LANES
LONDON N4 1JX

[name and address of premises to which application relates].

I also confirm that I am applying for, intend to apply for or currently hold a personal licence, details of which I set out below.

Personal licence number LN/000006777
[insert personal licence number, if any]

Personal licence issuing authority GREENWICH
[insert name and address and telephone number of personal licence issuing authority, if any]

 signed

OZGEN BALCI name (please print)

06/08/2013 dated

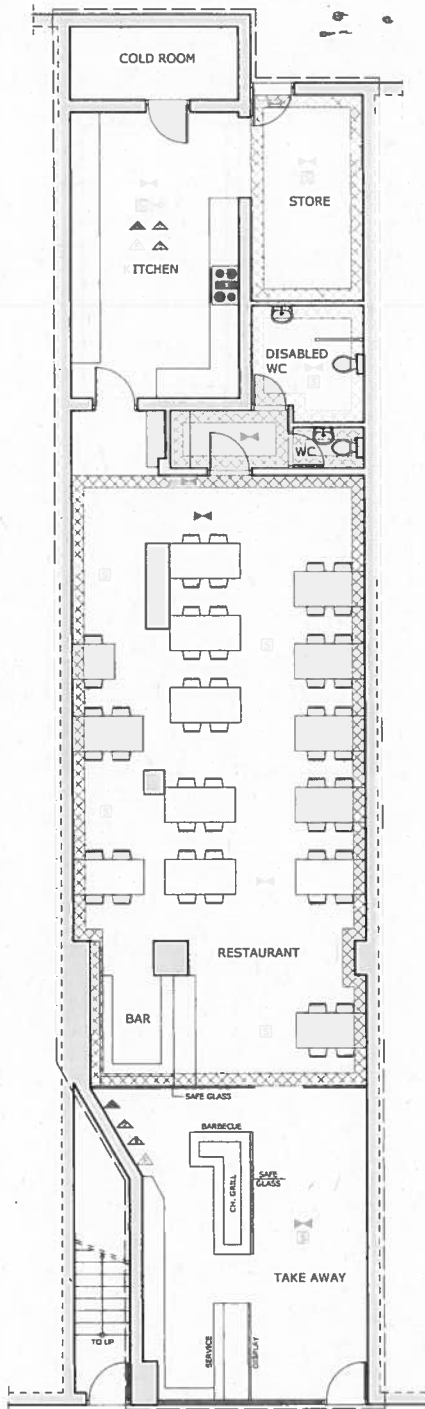

GROUND FLOOR PLAN
SCALE: 1/100

- LEGEND**
- SAFETY LIGHTING
 - SMOKE DETECTOR
 - HEAT DETECTOR
 - CARBON DIOXIDE FIRE EXTINGUISHER
 - 9 LT. WATER FIRE EXTINGUISHER
 - FIRE BLANKET
 - 9 LT. FOAM
 - INTERNALLY ILLUMINATED FIRE ESCAPE SIGN (BS 5266)
 - LIQUOR SALE
 - LIQUOR STORAGE
 - WC, PASSAGEWAY, ETC
 - KITCHEN STAFF AREA
 - AMBIT OF LICENSED PREMISES

THE CONTENTS OF THIS PLAN INCLUDING THE PRINTED NOTES ARE COPYRIGHT AND REPRODUCTION IN WHOLE OR PART IS NOT PERMITTED WITHOUT PRIOR CONSENT OF ANVA ARCHITECTURAL, ENGINEERING AND LICENSING IN WRITING.

HANCI RESTAURANT
6 GRAND PARADE
GREEN LANES
LONDON N4 1JX

-GROUND FLOOR PLAN

SCALE: 1/100 REF. NO: 115.13/01

DATE: AUGUST 2013 CHECKED BY: A.AY

anva architectural,
engineering and licensing

P.O. BOX 1827
LIFORD, IG2 7WJ
TEL: 020 8599 5036 FAX: 020 8586 4401
MOBILE: 077 10942923 / 079 30407212
E-MAIL: info@a-anva.co.uk

APPENDIX 2 – METROPOLITAN POLICE REPRESENTATION



**METROPOLITAN
POLICE**

Working together for a safer London

POLICE REPRESENTATION

Name and address of premises:

Hanci Restaurant, 6 Grand Parade N4 1JX

Type of Application: New Premises Licence.

I wish to make representation on the following:

- Prevention of crime and disorder

If this application were granted in full or part, I would recommend the following alterations be made to the licence conditions. I also suggest that additional conditions be attached to the licence, as set out below, to further promote the licensing objectives.

	Current Conditions	Recommendation
1	Venue shows time alcohol sales cease and venue closing to the public as the same time.	Haringey Licensing Policy is venue should cease serving alcohol 30 minutes before closing to allow a cooling off period.

If these conditions were accepted in full I would withdraw my representation.

Officer: Mark Greaves
Licensing Officer Haringey Police

Tel: 020 3276 0150

Mark.Greaves@Met.Police.UK

Date: 17th August 2013

APPENDIX 3 – LETTER OF REPRESENTATION FROM ‘OTHER PARTIES’

Anderson Chanel

From: Dominic Grant [dominicgrant@gmail.com]
Sent: 03 September 2013 15:43
To: Licensing
Cc: Dominic Grant; Sarah Baulch
Subject: Representations Against Granting of Late Premises Licence at Hanci Restaurant 6 Grand Parade, Green Lanes, London, N4 1JX

Dear Sir/Madam,

RE: Representations Against Late Premises Licence at Hanci Restaurant 6 Grand Parade, Green Lanes, London, N4 1JX

Details of Application

Hanci Restaurant, 6 Grand Parade, Green Lanes, London, N4 1JX (Ward - St Ann's)

Late Night Refreshment

Monday to Saturday 11pm to 2am

Sunday 11pm to 1am

Supply of Alcohol

Monday to Saturday 11am to 2am

Sunday 11am to 1am

For consumption on the premises

Hours open to the public

Monday to Saturday 7am to 2am

Sunday 8am to 1am

Premises Type

Restaurant

Details of Representations

Dominic Grant and Sarah Baulch

7a Grand Parade

Green Lanes

London

N4 1JX

Home Tel: 020 8826 5227

Dominic Work Tel: 07525 326737

Dominic: dominicgrant@gmail.com

Sarah: sarahbaulch@hotmail.com

On the Grounds of the Prevention of Public Nuisance

We strongly oppose the granting of a Late Night Refreshment licence and a Supply of Alcohol licence for Hanci Restaurant. This opposition is on the grounds of the inevitable dramatic increase in noise late at night associated with the granting of these licences at this address. Such noise arises due to (i) people gathering outside the restaurant, who are more likely to display antisocial or drunken and disorderly behaviour, due to (ii) parties and special events being held inside the restaurant well into the early hours of the morning and due to (iii) mechanical ventilation for cooking and air conditioning within and around the restaurant, as well as other machinery. All three of these issues have been a major problem at this address for local residents.

The licensing applications propose that alcohol and refreshment will be sold for consumption until 2am from Monday to Saturday and until 1 am on Sundays. Given the opening hours of 7am from Monday to Saturday and 8am on Sundays, this allows only 5 hours from Monday to Saturday and 7 hours on Sunday for local residents to rest, relax and sleep, without the noise of a bustling restaurant only metres away from their homes. The universally recognised minimum recommended period of sleep for adults is 8 hours - for children it is longer. Residents in this area already suffer noise nuisance and antisocial behaviour and to further add to this would be unacceptable.

Given the proximity of the restaurant to residential property, it being directly below residential dwellings, late night operation is a significant problem. Noise travels extremely easily to the above and adjoining residential dwellings through walls and connected building structures, as well as through the air. As already mentioned, late night noise from the restaurant previously occupying the property caused local residents significant disturbance, disrupting rest, relaxation and sleep, and causing fatigue.

In conclusion, we feel that the granting of a late night license for a property in such close proximity to residential dwellings is likely to result in significant Public Nuisance to local residents and should therefore not be permitted.

Yours Sincerely

Dominic Grant and Sarah Baulch